

LIMITA DE PROPRIETATE

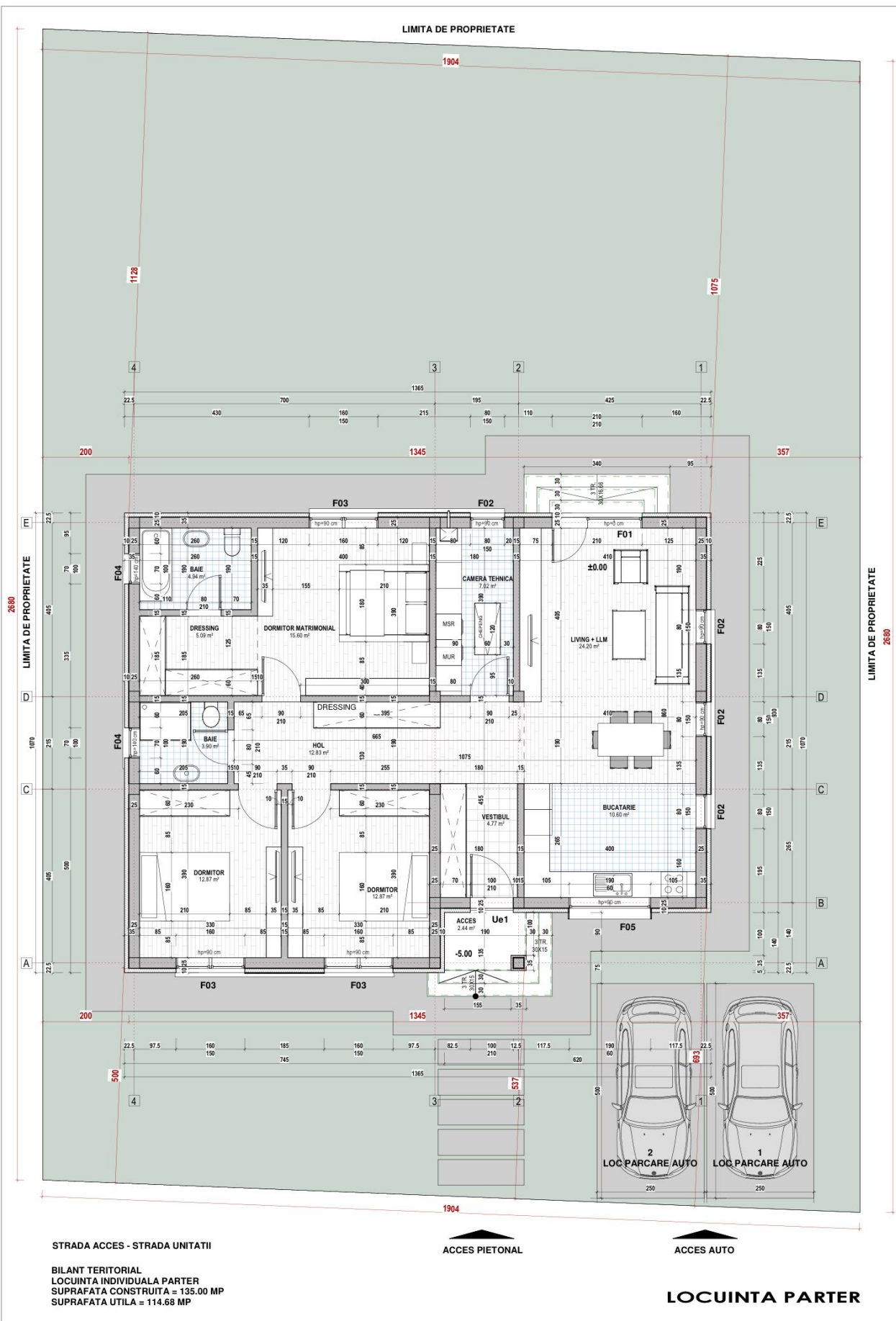

STRADA ACCES - STRADA UNITATII

BILANT TERITORIAL
LOCUINTA INDIVIDUALA PARTER
SUPRAFATA CONSTRUITA = 135.00 MP
SUPRAFATA UTILA = 114.68 MP

ACCES PIETONAL

ACCES AUTO

LOCUINTA PARTER